

CORNER RESTORATION

CORNER: SE COR. SEC. 2, TWP. 13 S., RANGE 33 E., W.M.

ORIGINAL SURVEY BY: John B. David

CONTRACT NUMBER: 131

CONTRACT DATE: June 8, 1869

SUBSEQUENT SURVEYS:

- ▶ DA McKeown, County Surveyor, Survey Record Book A Page 117, April 21 & 22, 1906.

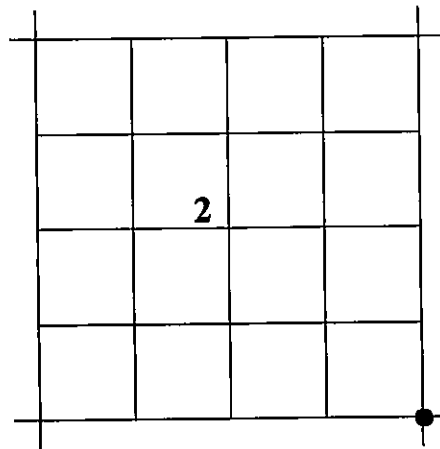

ORIGINAL DESCRIPTION: *Set Stone 16"x10"x5" for corner to Secs. 1, 2, 11 & 12.*

McKeown retraced the north line of Section 12, beginning at the SE Corner of Section 2 and measuring East. His field notes make no mention of what he found at the SE Corner of Section 2, or if he perpetuated the position in any way.

RESTORATION BY, STAMP AND DATE:

Jason L. Hatfield, PLS
Michael C. Springer, PLS

RECEIVED AND FILED
GRANT COUNTY SURVEYOR

MAR 15 2011

BY:

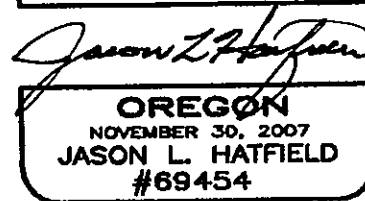
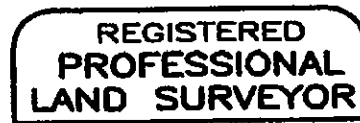

EXPIRES: 6/30/2011

March 3, 2011

See Record Map of Survey No. 1918

EVIDENCE FOUND: After a diligent search, I did not find the original marked stone. The corner of Sections 1, 2, 11 and 12 is determined at the corner of fences which extend West, South and East, being the best available evidence of the corner position. I verified the position by measuring to the found monuments a half mile West, a half mile South and one mile East.

DESCRIPTION OF MONUMENTS AND ACCESSORIES SET AND METHODS USED:

At the corner point: I set a 1½"x 30" galvanized iron pipe, 30" in the ground, with 2½ " brass cap attached, marked as shown below.

From which, I SET THE FOLLOWING REFERENCE POINTS:

- ▶ A 5/8"x30" iron pin bears N31°07'E, 36.97 ft., with attached yellow plastic cap marked "BENCHMARK SURVEYING" (in a north-south fence)
- ▶ A 5/8"x30" iron pin bears S87°35'E, 37.31 ft., with attached yellow plastic cap marked "BENCHMARK SURVEYING"
- ▶ A 5/8"x30" iron pin bears S01°25'W, 36.35 ft., with attached yellow plastic cap marked "BENCHMARK SURVEYING" (in a north-south fence)
- ▶ A 5/8"x30" iron pin bears S88°29'W, 31.90 ft., with attached yellow plastic cap marked "BENCHMARK SURVEYING" (in an east-west fence)

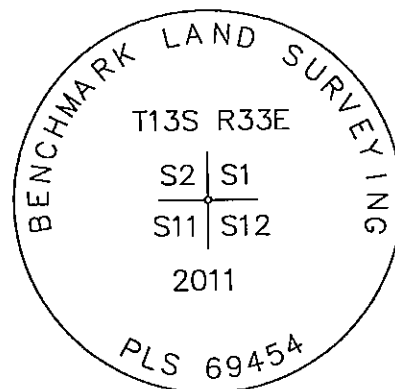

Used RTK GPS to measure accessories. Placed an orange fiberglass witness post alongside the brass cap. Bearings are based on Record Map of Survey No. 1918.